

**LEGEND**

- PLANNING APPLICATION BOUNDARY
- PAVEMENT TYPE 1  
CAR PARK FULL DEPTH FLEXIBLE PAVEMENT CONSTRUCTION
- PAVEMENT TYPE 2  
INTERNAL ROAD FULL DEPTH FLEXIBLE PAVEMENT CONSTRUCTION
- PAVEMENT TYPE 3  
MAIN ROAD FULL DEPTH FLEXIBLE PAVEMENT CONSTRUCTION
- PAVEMENT TYPE 4  
BUS TURNING CIRCLE FULL DEPTH RIGID PAVEMENT CONSTRUCTION
- PAVEMENT TYPE 5  
ROADS OVERLAY OF EXISTING FLEXIBLE PAVEMENT
- PAVEMENT TYPE 6  
CONCRETE FOOTPATH
- PROPOSED LANDSCAPING  
SEE LANDSCAPING LAYOUT FOR DETAILS.
- PROPOSED TREES

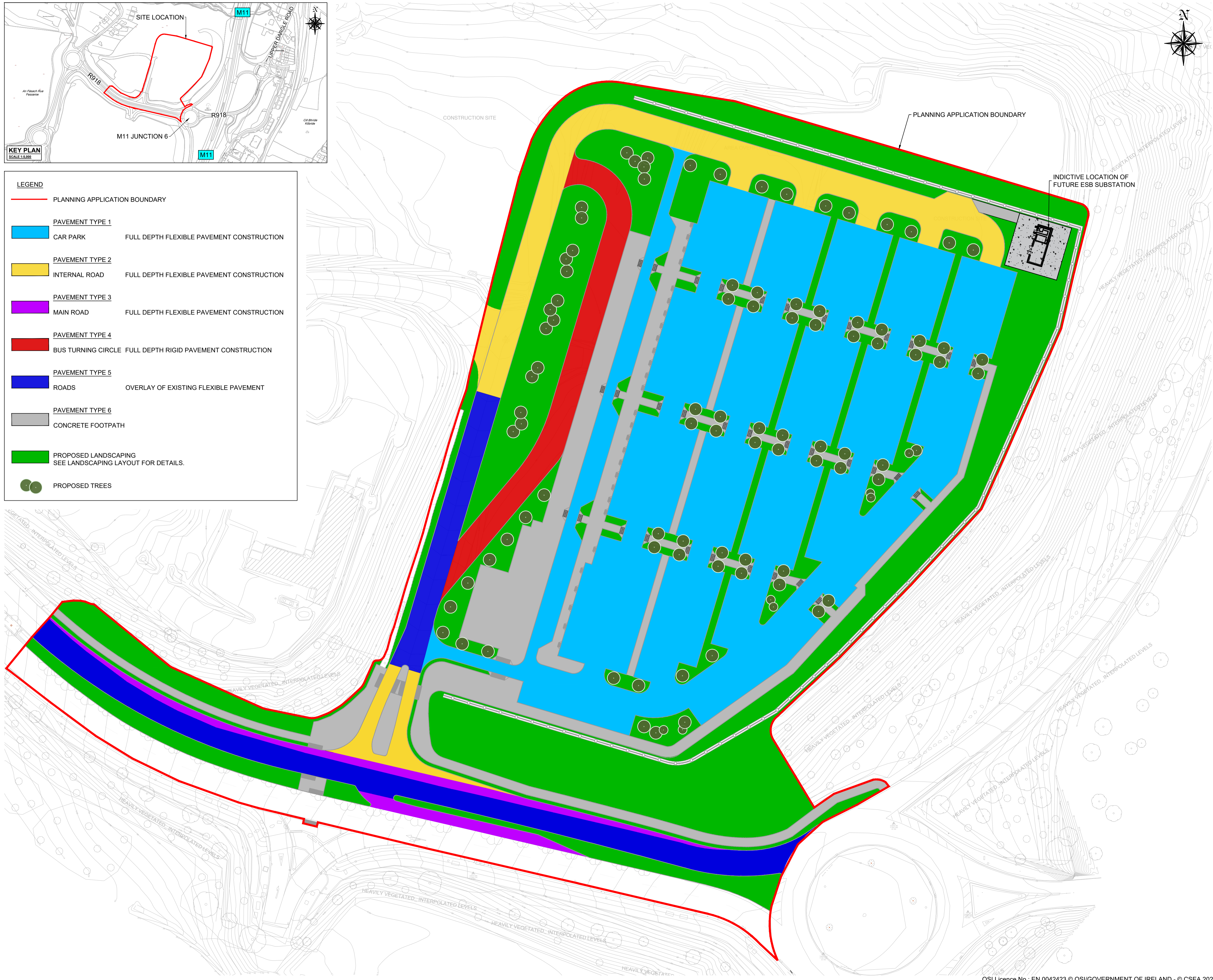

DRAWING IS PRODUCED USING THE IRISH TRANSVERSE MERCATOR (ITM) GEOGRAPHIC COORDINATE SYSTEM **A1**



Tionscatal Éireann  
Project Ireland  
**2040**



|  |  |  |  |  |
|--|--|--|--|--|
|  |  |  |  |  |
|  |  |  |  |  |
|  |  |  |  |  |
|  |  |  |  |  |

|     |                     |       |         |          |
|-----|---------------------|-------|---------|----------|
| P03 | ISSUED FOR PLANNING | SM    | IR      | 28/07/23 |
| Rev | Description         | Drawn | Checked | Date     |

**Clifton Scannell Emerson Associates**

Clifton Scannell Emerson Associates Limited  
Consulting Engineers,  
3rd Floor The Highline,  
Bakers Point, Pottery Road,  
Dun Laoghaire, Co. Dublin,  
Ireland, A96 KW29

T. +353 1 288 5006  
F. +353 1 283 3406  
E. info@csea.ie  
W. www.csea.ie

|              |  |
|--------------|--|
| Client       | WICKLOW COUNTY COUNCIL                   |
| Project      | FASSAROE PARK AND RIDE FACILITY          |
| Dwg. Title   | PROPOSED SURFACE TREATMENT PLAN          |
| Drawn By     | SM                                       |
| Date         | JULY 2023                                |
| Checked By   | BD                                       |
| Scale        | 1:500 @ A1                               |
| Project Code | 20_008N - CSE - GEN - XX - DR - C - 3000 |
| Status Code  | S2 PART VIII APPROVAL                    |
| Revision     | P03 FOR PLANNING                         |